

# Heated Lines for Continuous Emissions Monitoring



## Durable Industrial Strength Heated Products for CEMS

Quality Heated Lines for Chemical Analysis of Exhaust Gases

High Performance Insulation and Pressure-Tested Cores

Repair and Recondition old Lines to Save Dollars and Avoid Downtime.

Extreme Flexibility in all Temperature Conditions

Integrated Heating Elements for Efficient Heat Transfer—Zero Cold Spot

Flexotherm® manufactures heated lines expressly for use in the chemical analysis of exhaust gases.

We have built a reputation as a quality manufacturer of durable industrial-strength electrically heated products since 1994.



All of our products are precision-engineered to exceed industry and EPA standards and are covered by a 2-year Limited Warranty.

### Heated Lines for CEMS

- Durable electric-traced single and multi-tubed heated bundles for Continuous Emissions Monitoring Systems.
- Electric Traced bundles for instrument and process analyzer lines.
- Pre-insulated tubing bundles for steam supply and condensate return
- Steam traced bundles used for impulse lines, flow measurement and instrument lines
- Special bundles for monitoring and analysis applications

### Product Features

- Six types of casings
- Integrated heating elements for efficient heat transfer.
- High performance insulation and pressure tested hose cores.
- Heating elements are made of high grade heat conducting alloys.
- Extreme flexibility in any temperature.
- Indestructible hose-end cap.
- Sample cores available in PFA and PTFE Teflon—optional 316 / Electro-polished Stainless.
- Inner tubes in PFA Teflon™ or 316
- Stainless steel braid provides outstanding resistance to heat, pressure, pulsing, flexing and vibration.
- Innovative connector to attach multiple lines without strain on fittings.
- Positive braid lock ensures that strain is absorbed by the braid.
- Zero Cold-Spot Construction



### Repairs and Reconditioning

- Flexotherm has the technology and expertise to repair damaged and worn stack lines for CEMS which can result in significant cost savings and avoid crucial downtime.
- We repair Flexotherm heated lines and those made by other manufacturers.
- Our technicians can restore your lines to virtually new condition, whether they require a recore, replacement of components, rewiring or rewinding.
- Innovative Re-tube design for quick repair on damaged or contaminated sample core
- Our process includes, test / diagnose, repair, replacement parts, post-testing and expediting back to your site.



### Flexotherm® Heated Emissions Sample Lines

GA Series	GT Series	GD Series
<ul style="list-style-type: none"> <li>✓ 200° C Continuous Operation</li> <li>✓ Meets CFR Specifications</li> <li>✓ Temperature Data Profiles Available</li> </ul>	<ul style="list-style-type: none"> <li>✓ 200° C Continuous Operation</li> <li>✓ Economical Alternative to GA Series</li> <li>✓ Temperature Data Profiles Available</li> </ul>	<ul style="list-style-type: none"> <li>✓ 125° C Continuous Operation</li> <li>✓ Designed for maintaining samples above dewpoint.</li> </ul>

### Heated Products for CEMS

Industrial Strength Electrically Heated Products

Quality Heated Lines for Chemical Analysis of Exhaust Gases

Heated Sample Probes Designed for Extraction and Thermal Control of Gaseous Emissions Samples

Insulating Jackets with Integral Heating Elements for Efficient Heat Transfer

Single or Multi-Channel Temperature Control Modules

Repair and Recondition to Save Dollars and Avoid Crucial Downtime.

#### Flexotherm Heated Product Line

We carry a full line of world-class quality heated products and components including:

- Temperature Control Modules
- Heated Sample Probes
- Heated and Insulating Jackets, Blankets, Hot-Pockets
- Industrial Heaters
- Temperature Sensors
- Custom Engineered Products— We have the expertise to design and manufacture custom products to your exact specifications.



#### Temperature Control Modules

- Single or Multi-Channel Temperature Control Modules in ready-to-use configurations
- Programmable digital controls with LED displays
- Indestructible Metal Exterior
- Individually-fused control outputs and customer specified temperature sensors

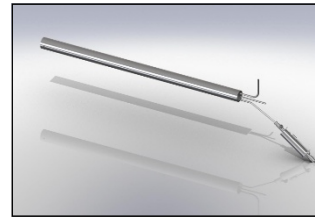

#### Heated Sample Probes

- Heated sample probes for emissions sampling and conditioning custom-configured to fit your application.
- Designed for applications requiring extraction and thermal control of gaseous emissions samples.
- Proprietary heater element with superior insulation
- Innovative packaging technique
- All stainless steel exterior for maximum durability
- Sample extraction tip, sample outlet port, span tip / overflow port and thermocouple probe port.

#### Heated / Insulating Jackets, Blankets and Hot Pockets

- Custom-designed flexible insulation covers for optimum fit and maximum durability.
- Integral heating elements for efficient heat transfer
- Rugged, multi-strand, knitted, serpentine heating tape element for long life



#### Flexotherm<sup>®</sup> Heated Products

- *Industrial Strength electrically heated products*
- *Custom-Engineered Products to exacting Specifications*
- *All Flexotherm Heated Products are Backed by a Two*



### Warranty

All of our quality heated products are backed by a limited Two-Year Warranty

- Full Coverage on repairs caused by defects in workmanship
- Quick turn-around time on repairs
- Phone support during repair process.
- Repaired on-site whenever possible to minimize downtime.



### About Us

Flexotherm<sup>®</sup> is a division of Neptech, Inc.—manufacturer of quality heated products since 1994. Our mission is to partner with industry leading companies to harness technologies that help reduce emissions and meet corporate, government and EPA standards.

We have built a quality reputation for consistently delivering innovative and cost-effective solutions that benefit our customers' bottom line.

Our multi-faceted engineering, design and manufacturing capabilities enable us to provide a complete array of products and services to R&D facilities and OEMs worldwide.

### Contact Us

If you have any questions or need additional information, please call (810) 225-2222  
Or visit: [www.Flexotherm.net](http://www.Flexotherm.net)  
email: [robon@flexotherm.net](mailto:robon@flexotherm.net)

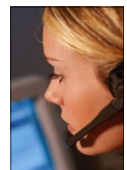

# FLEXOTHERM<sup>(R)</sup>

## A Division of Neptech Inc.

2000 E. Highland Drive, Highland, MI 48357  
810.225.2222 Fax: 810-225-1155  
[www.Neptechinc.com](http://www.Neptechinc.com) [www.FLEXOTHERM.net](http://www.FLEXOTHERM.net)